

Fin Shaft

Caleb A. Sylvester, Christopher J. Cannell

Material: 316 Stainless Steel

All surfaces machine tool finish except where noted.

Break all edges, approximately .127mm[.005"]R.

Description: Molded into the fin. Connects the fin with the fin crank.

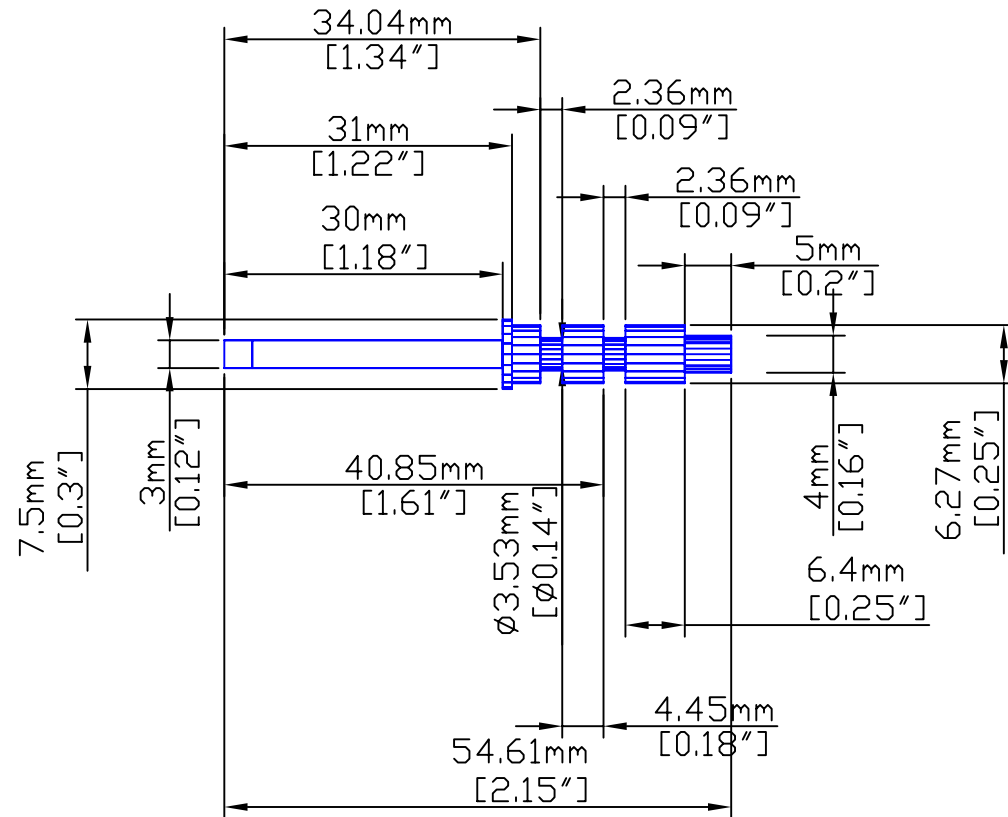
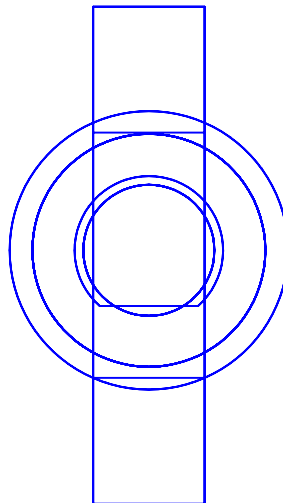
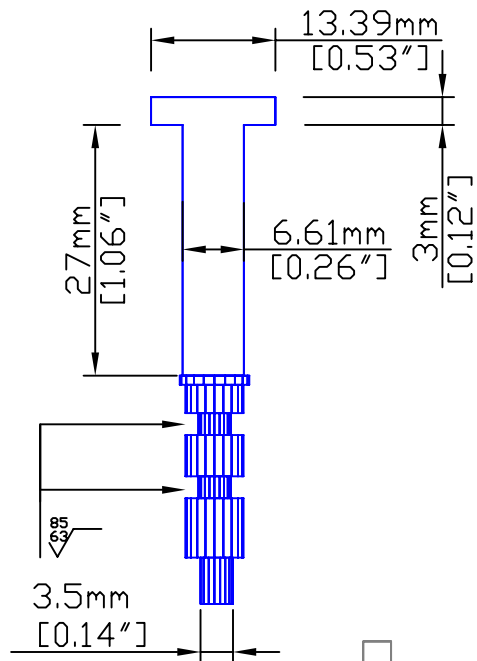

NOTE - please note the flat spot required on the end-most portion of the fin shaft. Dimensions were left off of this view in order to more easily show the flat spot. This view was achieved by scaling the fin shaft by 4 times.